

## **Hammersmith and Fulham Draft Local Plan Proposals Map Changes**

## Explanatory Note

The changes listed below include proposed additions, deletions and amendments to the existing Core Strategy 2011 Proposals Map. All other designations on the Proposals Map remain unchanged.,

**Table 1: Designations to be ADDED**

<b>Designation</b>	<b>Proposed additions</b>	<b>Reason for the changes</b>	<b>Map Ref</b>
<b>Regeneration Areas</b>	Old Oak Regeneration Area (OORA) - to cover same area that was previously called the Park Royal Opportunity Area. The area will also be identified as new Inset Area D.	To identify a new regeneration area in the Local Plan.	AD1
<b>Strategic Site Policies</b>	Old Oak Common Station (OORA1) - includes a section of Old Oak Common railway sidings and ancillary railway buildings.	To identify the 3 new strategic sites in the Old Oak Regeneration Area.	AD2
	Old Oak South (OORA2) - includes the rest of the area south of the Grand Union Canal that wraps around OORA1.		AD3
	Old Oak North (OORA3) - the area north of the Grand Union Canal.		AD4
	Hammersmith Flyover, A4 and adjoining land (HRA3) - to include A4 land running from Colet Gardens in the east to the Cromwell avenue underpass in the west. Includes the Hammersmith Gyratory, the Broadway Centre, the area south of Black's Road to Hammersmith Bridge Road, the British Transport Police Station and adjacent land to the east on Talgarth Road, the Ark, West London Magistrates Court and Linacre Court.	To identify new strategic site in the Hammersmith Regeneration Area.	AD5
	Imperial Gasworks National Grid (SFRR1) to include land owned by National Grid.	To include new strategic site in the South Fulham Riverside	AD6

<b>Designation</b>	<b>Proposed additions</b>	<b>Reason for the changes</b>	<b>Map Ref</b>
		Regeneration Area.	
<b>HS2 -extent of safeguarding</b>	New safeguarding area on railway sidings and strip of land over St Mary's RC Cemetery	To show extent of new safeguarding direction.	AD7
<b>Retail designations</b>	New Neighbourhood Parade: Parsons Green Lane (47 Parson's Green Lane, 51 Parson's Green Lane, 61 to 77 Parson's Green Lane, 1-3 Parson's Green, Dexter Court and Brigade House at Parson's Green Lane.	To reflect proposed new designation.	AD8

**Table 2: Designations to be DELETED**

<b>Designation</b>	<b>Proposed deletions</b>	<b>Reason for the changes</b>	<b>Map Ref</b>
<b>Regeneration Areas</b>	Park Royal Opportunity Area	Replace with designation with Old Oak Regeneration Area	N/A
<b>Strategic Site Policies</b>	Strategic Site PR1- Old Oak Common Sidings	Replaced by new strategic site included in OORA	N/A
	Strategic Site PR2- North Pole Depot	Replaced by new strategic site included in OORA	N/A
	Strategic Site FRA2- North End Road/ Lillie Road/ Chuter Ede House/ Coomer Place car park strategic site and regeneration area.	No longer identified as a strategic site.	N/A
	HTC3- Hammersmith Embankment strategic site and estate regeneration area (Queens Wharf and Riverside Studios; Queen Caroline Estate river frontage; and Hammersmith Embankment former office site).	Hammersmith Embankment development is underway; estate regeneration is no longer part of Council's Housing Strategy; and other parts of site can be progressed without the need for a site policy.	N/A

<b>Designation</b>	<b>Proposed deletions</b>	<b>Reason for the changes</b>	<b>Map Ref</b>
<b>Employment Zone/ Strategic Industrial Land</b>	Remove designation within Park Royal Opportunity Area	To reflect the designation as Old Oak Regeneration Area	N/A
<b>Housing Estate Regeneration Areas</b>	Remove existing designations within Fulham Regeneration Area, White City Regeneration Area and Hammersmith Regeneration Area.	Estate regeneration no longer part of council's Housing Strategy.	N/A

**Table 3: Designations to be AMENDED**

<b>Designation</b>	<b>Proposed amendments</b>	<b>Reason for the change</b>	<b>Map Ref</b>
<b>Regeneration Areas</b>	Hammersmith Regeneration Area: Rename title of Inset Map and amend boundary to include A4 south of Hammersmith Friends Meeting House and land south of Down Place; include A4 up to Royal Ballet School and Linacre Court north of the A4; and remove Queen Caroline Estate, Riverside Studios and Queens Wharf as well as the area including Hammersmith Embankment and remove properties at 1-48 Cromwell Avenue (Pocklington Estate) and 209-215 King Street.	New name. Boundary changes to allow for inclusion of a policy for the Flyover strategic site and affected adjacent land.. Areas to be deleted can be adequately considered under borough-wide development management policies.	AM9
	White City Regeneration Area: rename title of Inset Map.	New name.	N/A
<b>Strategic Site Policies</b>	Rename existing site WCOA1 to read WCRA1 and include BBC One and BBC Media Village within boundary, as well as Shepherd's Bush Bus Station and the DIMCO building north of Westfield London.	To acknowledge that these sites are also expected to come forward for development within the Plan period.	AM10
	Rename existing WCOA2 to read WCRA2 and redraw boundary to combine existing 5 parts of former WCRA2.	To improve legibility.	AM11
	Rename WCOA3 to read WCRA3.	To reflect new referencing	N/A

<b>Designation</b>	<b>Proposed amendments</b>	<b>Reason for the change</b>	<b>Map Ref</b>
	Amend boundary of FRA1 to include previous three separate parts of FRA1 as well as the area covering Empress Place, Langtry Place and Rickett Street; the pub on corner of West Cromwell Road and North End Road; and ad hoc strips of railway and highways land	To improve legibility and link up the separate parcels of land.	AM12
	Rename HTC1 to read HRA1 and amend boundary to remove Thomas Pocklington Trust Properties at 1-48 Cromwell Avenue and 209-217 King Street.	To reflect revised site boundaries.	AM13
	Amend HTC2 to read HRA2 and extend boundary to include Lyric Square and the south side of King Street between Queen Caroline Street and Angel Walk at 75 King Street, including all properties to the north of Blacks Road.	To identify the new enlarged strategic site.	AM14
<b>Thames path</b>	<p>Delete section of Thames Path National Trail- PROPOSED that runs between River Terrace and the river.</p> <p>Delete section of Thames Path National Trail TEMPORARY that diverts along Chancellors Road and through the Hammersmith Embankment (Fulham Reach) site. Add a new section of Thames Path National Trail- PROPOSED' along front of Queen's Wharf.</p> <p>Add a new section of Thames Path National Trail - EXISTING along front of Hammersmith Embankment (Fulham Reach) site.</p>	<p>To reflect proposal for new section along Queens Wharf</p> <p>To reflect completion of new section (see below) To reflect proposed new section.</p> <p>To reflect completion of new section of the Thames Path</p>	AM15

<b>Designation</b>	<b>Proposed amendments</b>	<b>Reason for the change</b>	<b>Map Ref</b>
<b>Retail designations</b>	Add 124 to 128 and 157 to 165 Askew Road to Askew Road Key Local Centre.	To reflect existing retail provision.	AM16
	Add 78 to 84 North End Road to North End Road Key Local Centre.	To reflect existing retail provision.	AM17
	Add (Sainsbury's on former Janet Adegoke Centre) at Bloemfontein Road neighbourhood parade.	To reflect existing retail provision.	AM18
	Add 412 to 420 Uxbridge Road West to Uxbridge Road West neighbourhood parade.	To reflect existing retail provision.	AM19
	Change name of Greyhound Road neighbourhood parade to Fulham Palace Road North and add 168 to 190, 169 to 177, 208 to 220, 193 to 207 and 209 to 211 Fulham Palace Road & 392 to 402 Lillie Road. Remove 2 to 10 and 3 to 11 Greyhound Road.	To reflect existing retail provision.	AM20
	Add 132 Wandsworth Bridge Road to Wandsworth Bridge Road (North).	To reflect existing retail provision.	AM21
	Add 77 to 85 Goldhawk Road at Goldhawk Road satellite parade.	To reflect existing retail provision.	AM22
	Add 68 to 80 Fulham Palace Road to Fulham Palace Road satellite parade.	To reflect existing retail provision.	AM23
<b>Views from Bridges</b>	View from Putney rail bridge- symbol should be shown to effect views toward the north east only.	To amend a previous error.	N/A
<b>Conservation Areas</b>	Amend boundary of Bradmore Conservation Area.	To reflect Conservation Area boundary changes	AM24



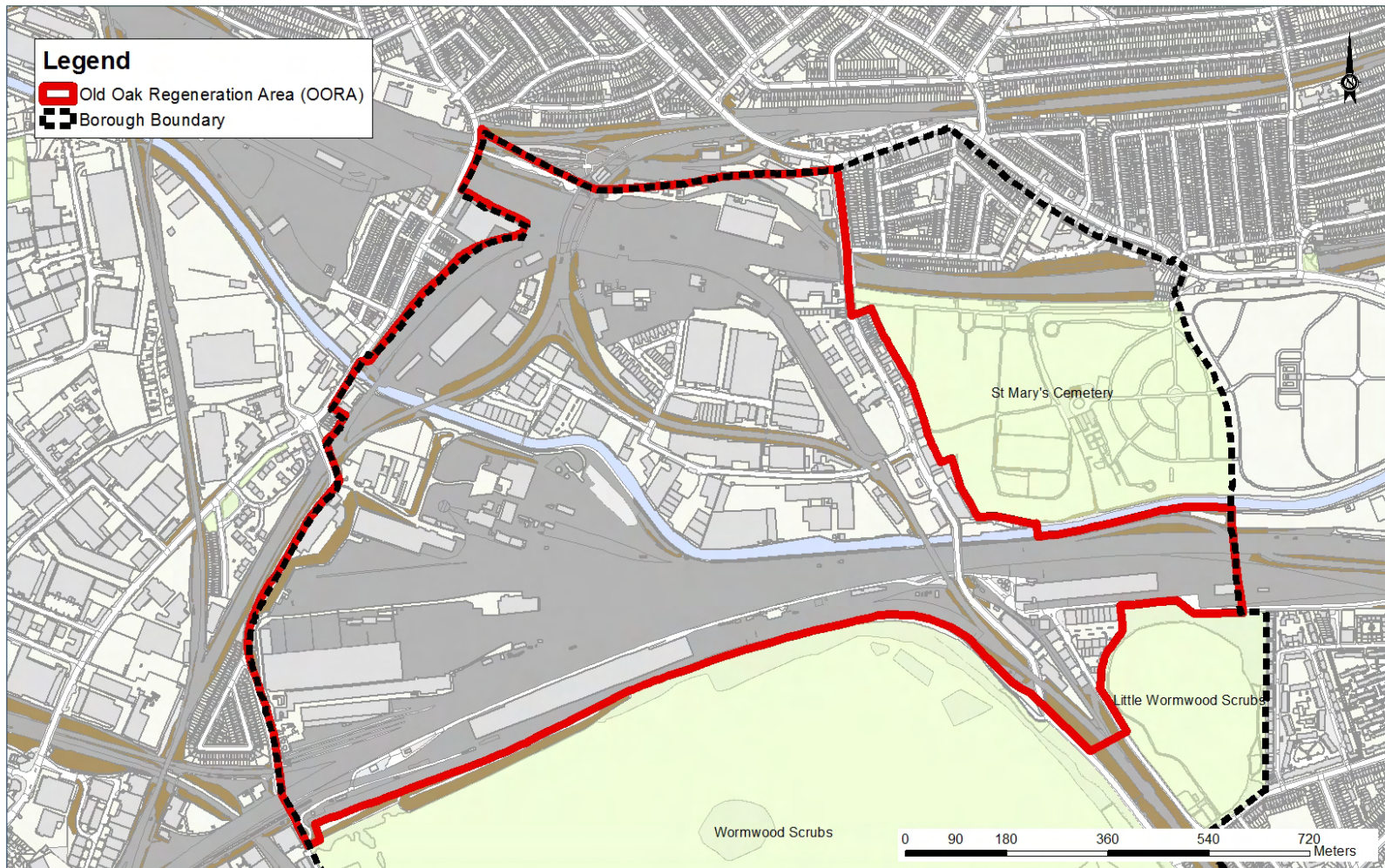

**Map AD1:  
Old Oak Regeneration Area (OORA)**

© Crown copyright and database rights  
2014 Ordnance Survey Licence No. LA10019223

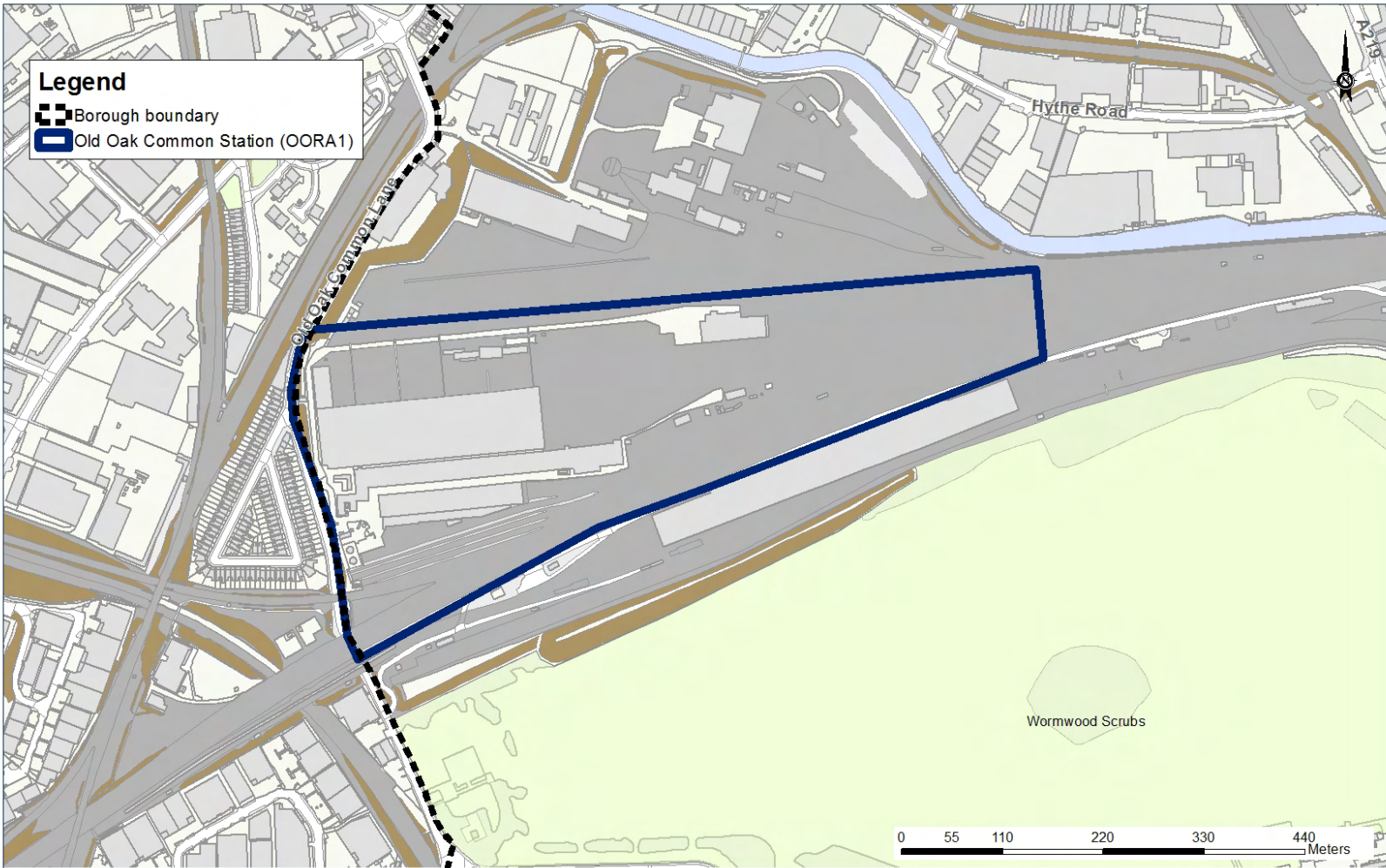

**Map AD2:  
Old Oak Common Station (OORA1)**

© Crown copyright and database rights  
2014 Ordnance Survey Licence No. LA10019223

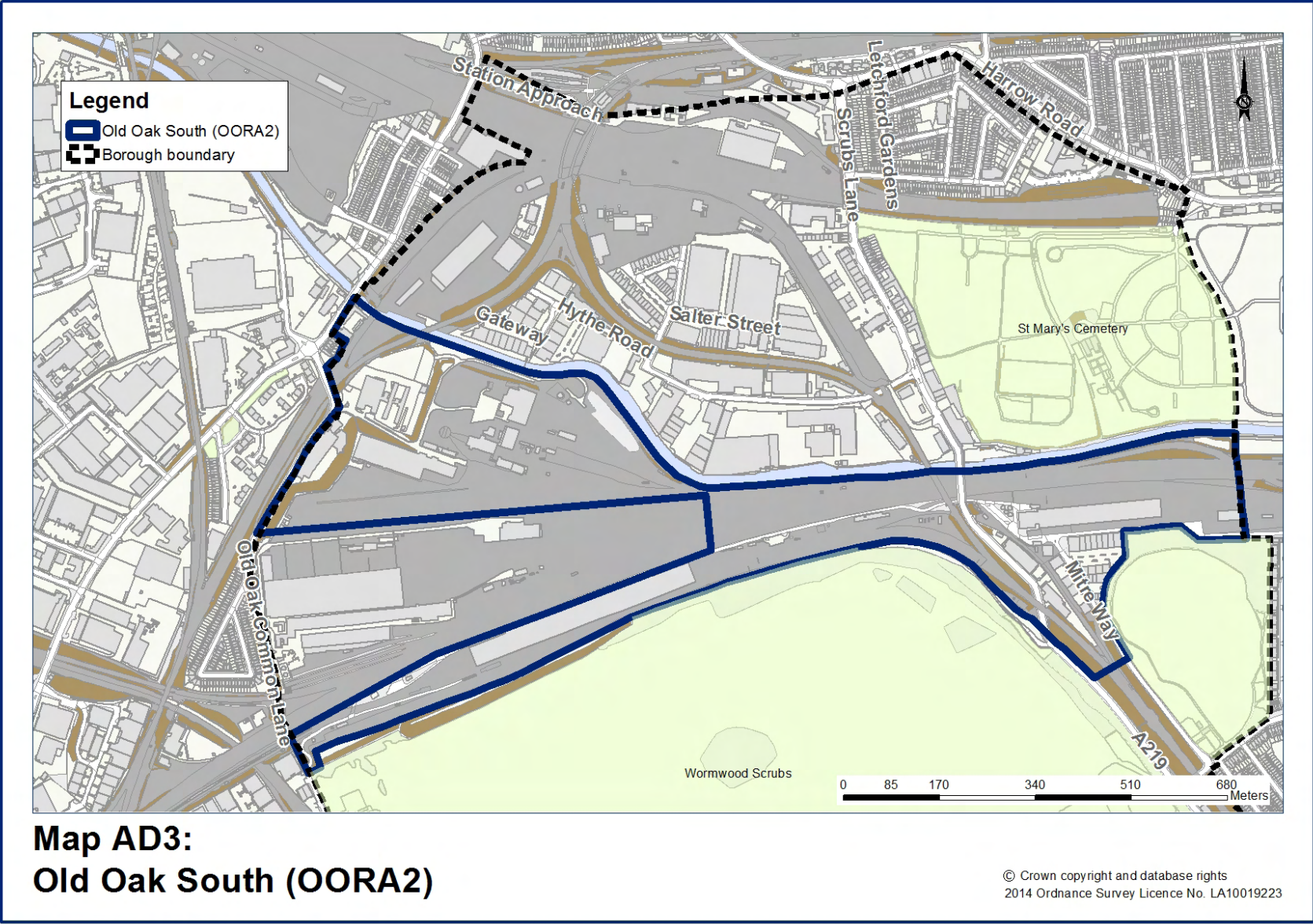

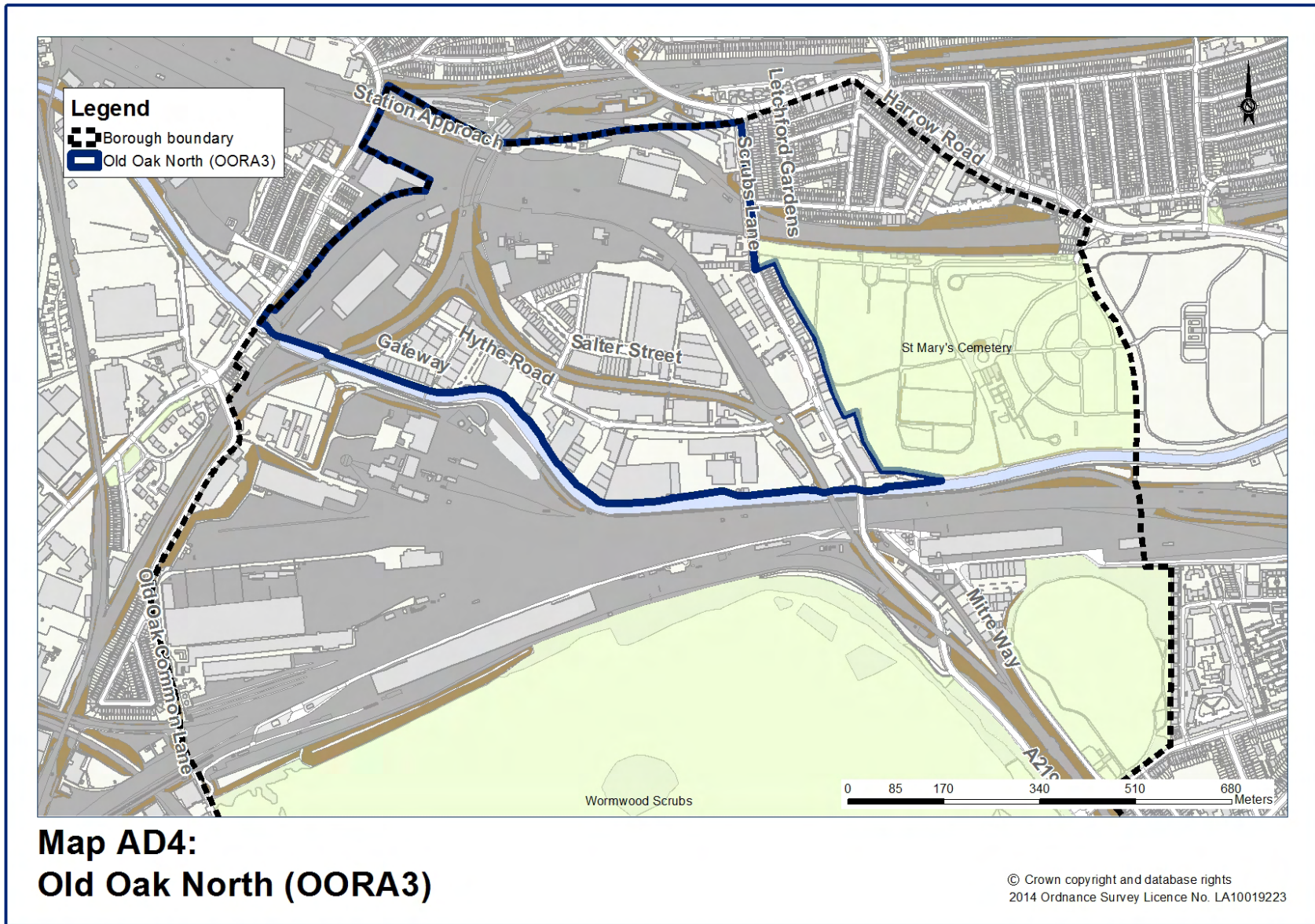

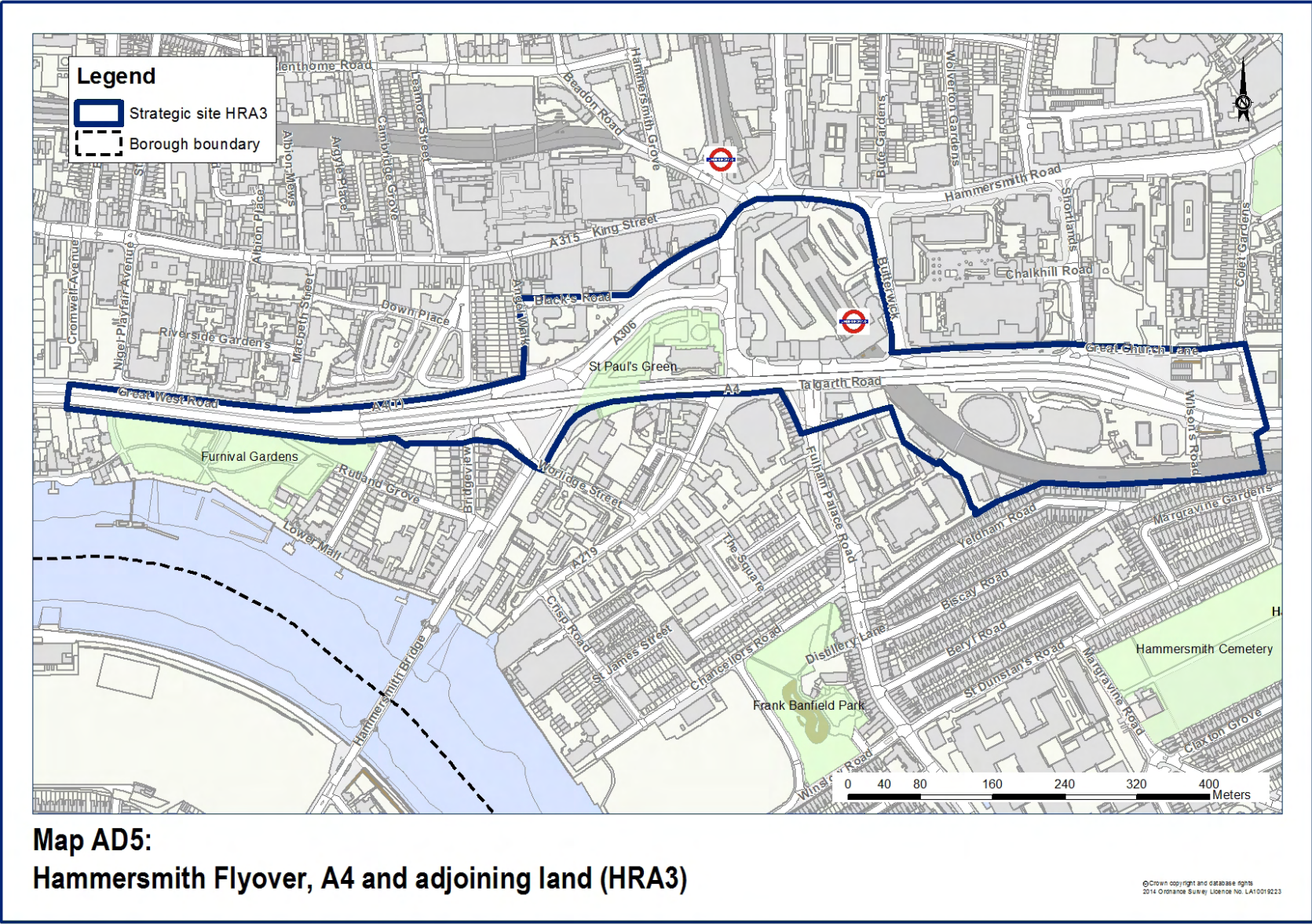

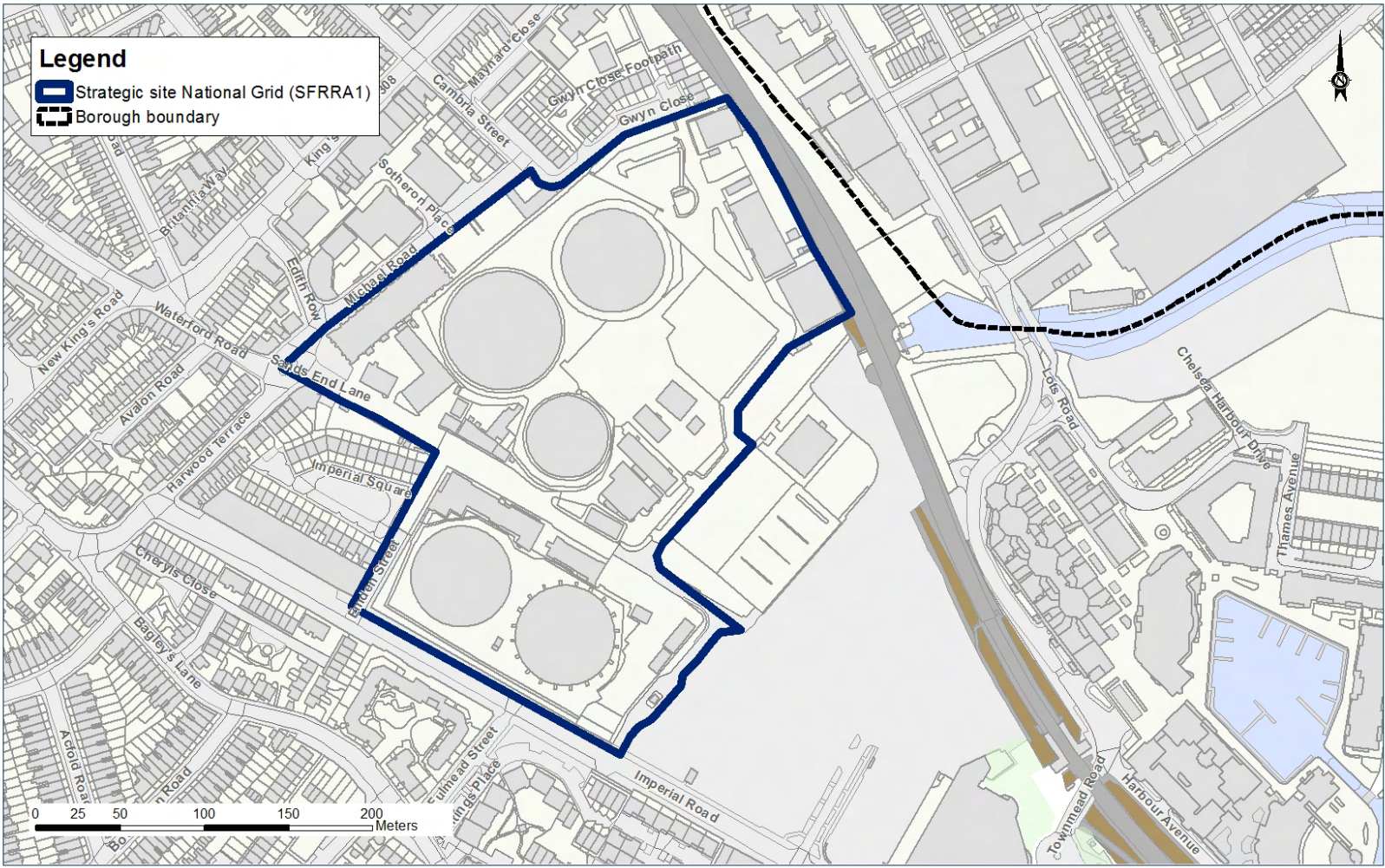

**Map AD6:  
Imperial gasworks National Grid (SFRR A1)**

© Crown copyright and database rights  
2014 Ordnance Survey Licence No. LA10019223

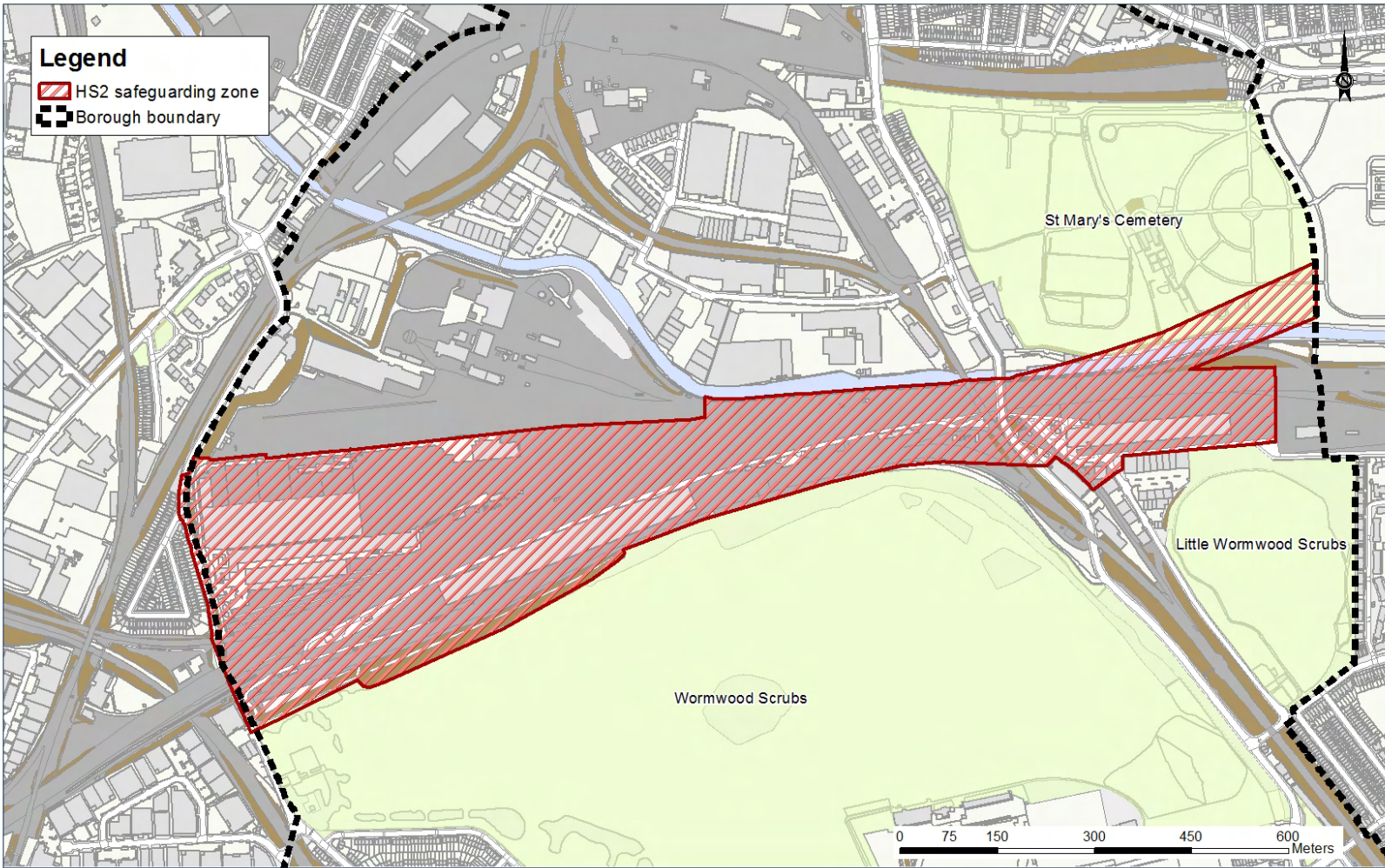

**Map AD7:  
Extent of HS2 Safeguarding in H&F**

© Crown copyright and database rights  
2014 Ordnance Survey Licence No. LA10019223

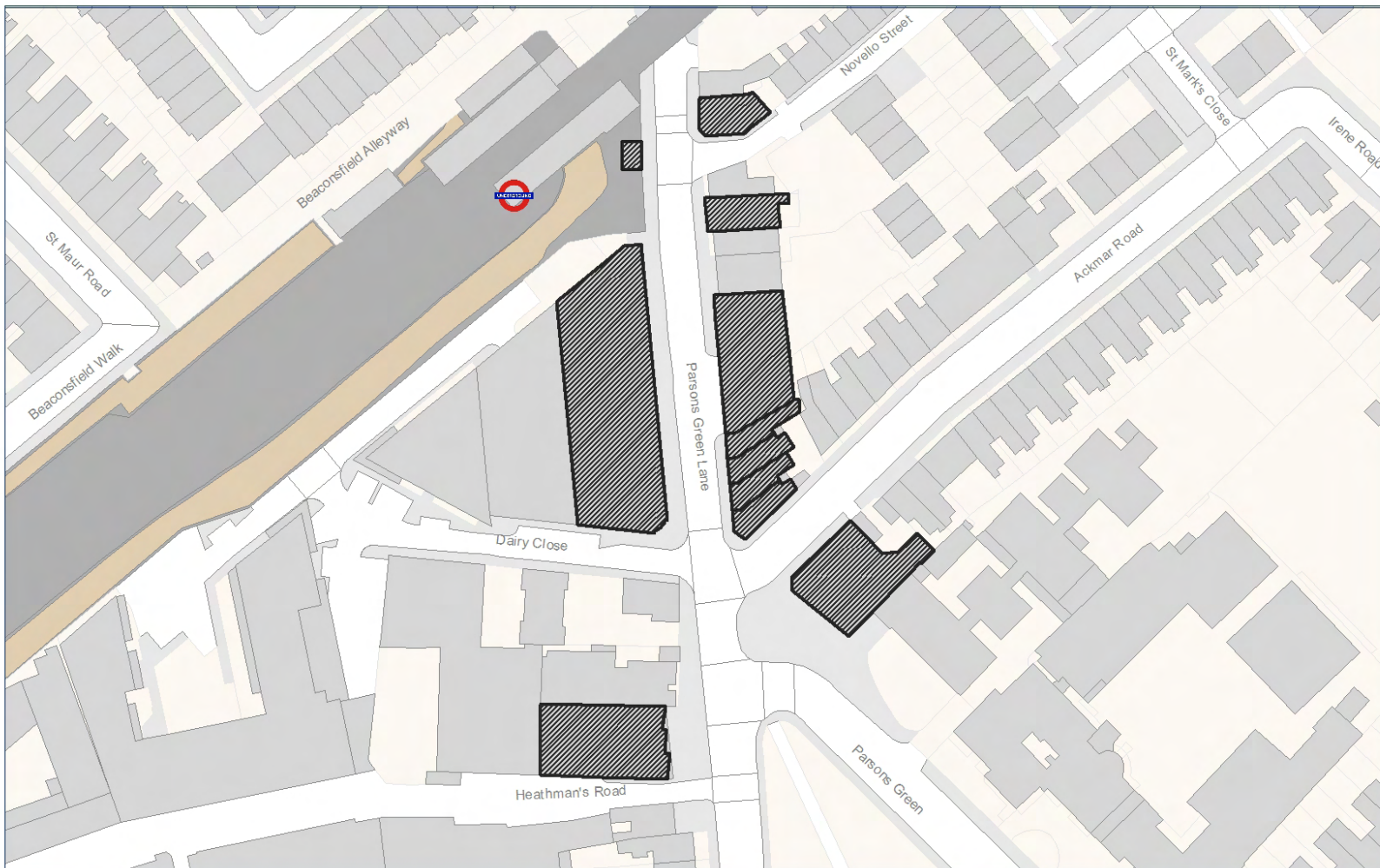

**Map AD8:  
Parsons Green Lane (Neighbourhood Parade)**

© Crown copyright and database rights  
2014 Ordnance Survey Licence No. LA10019223



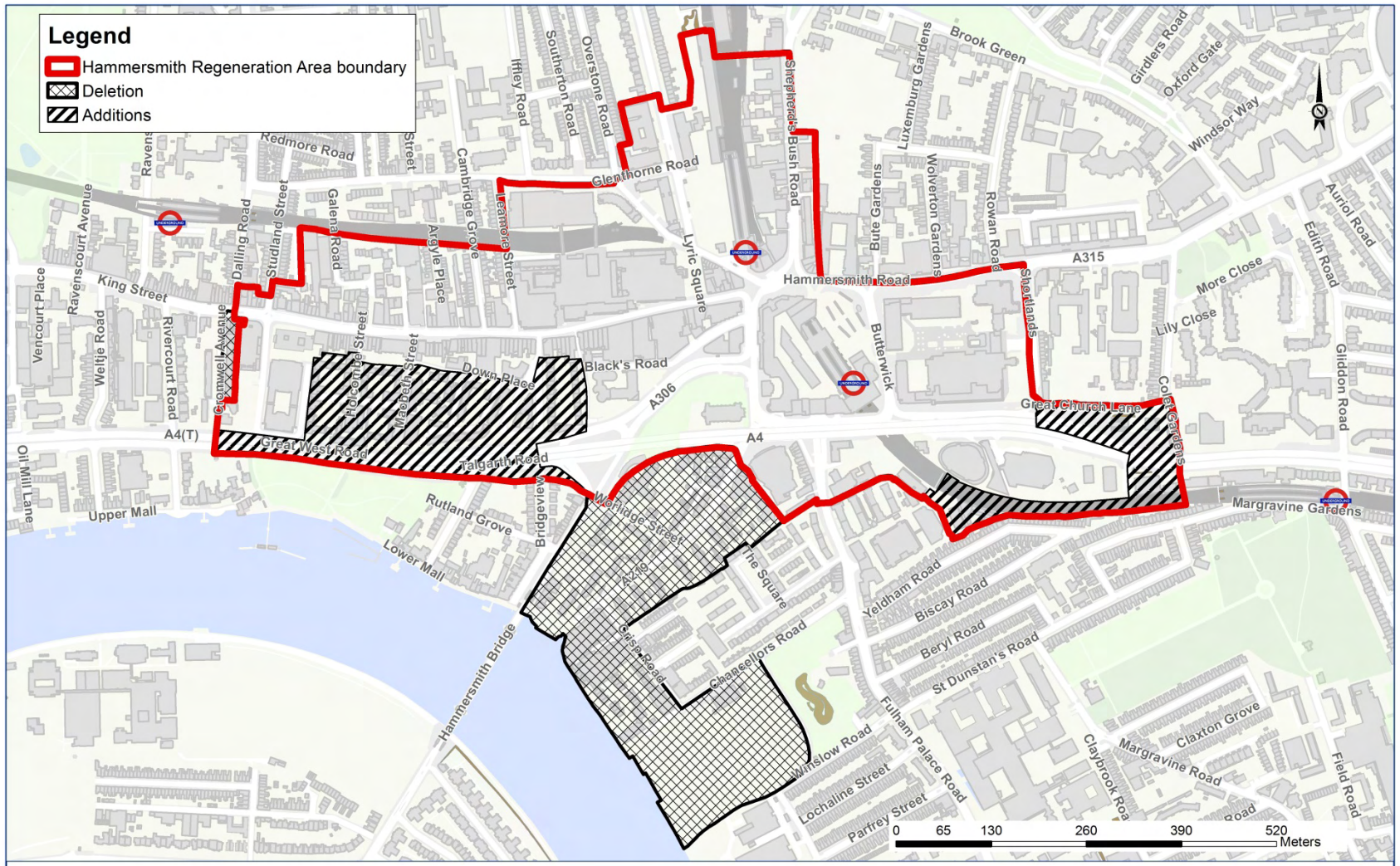

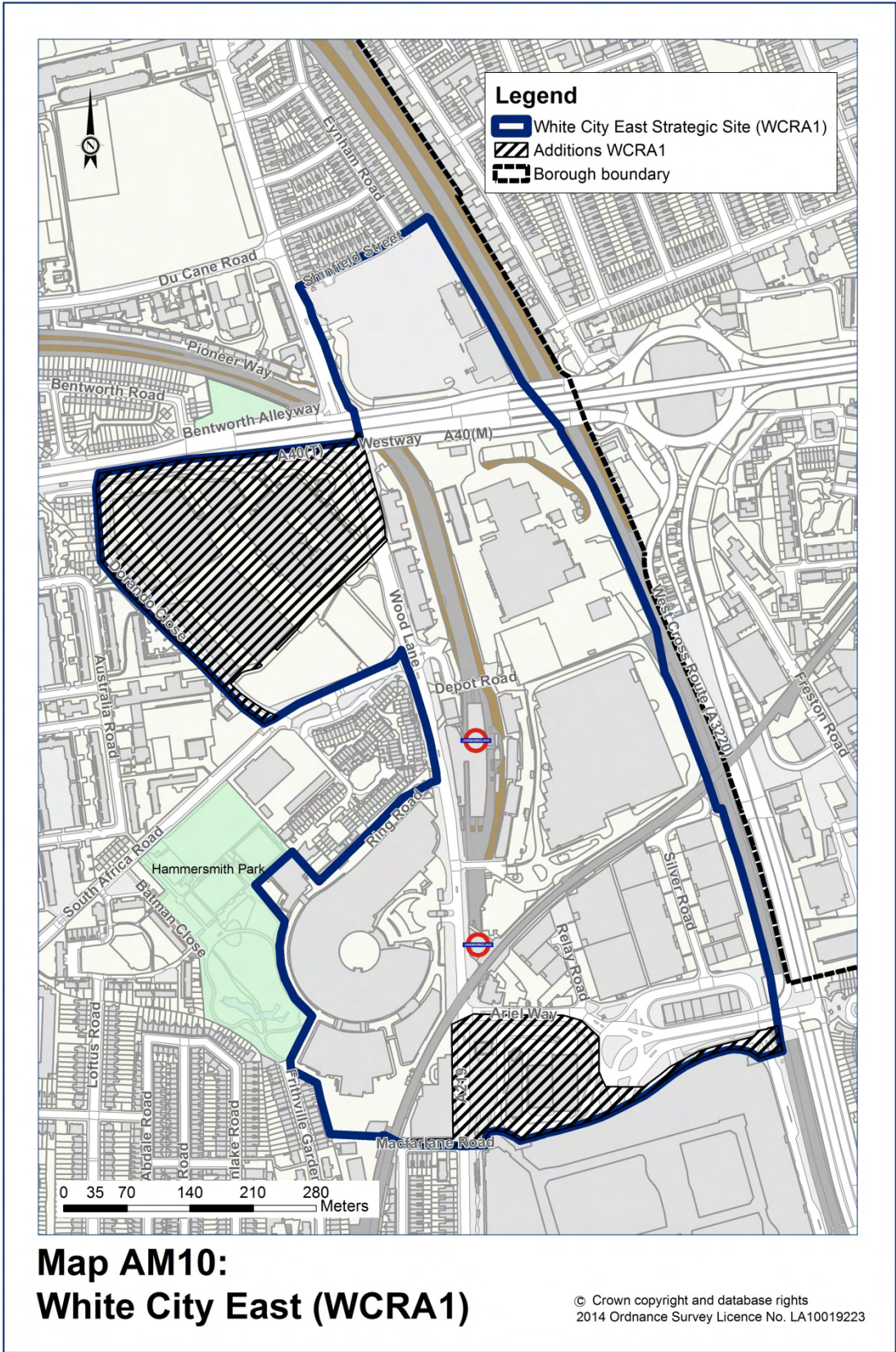



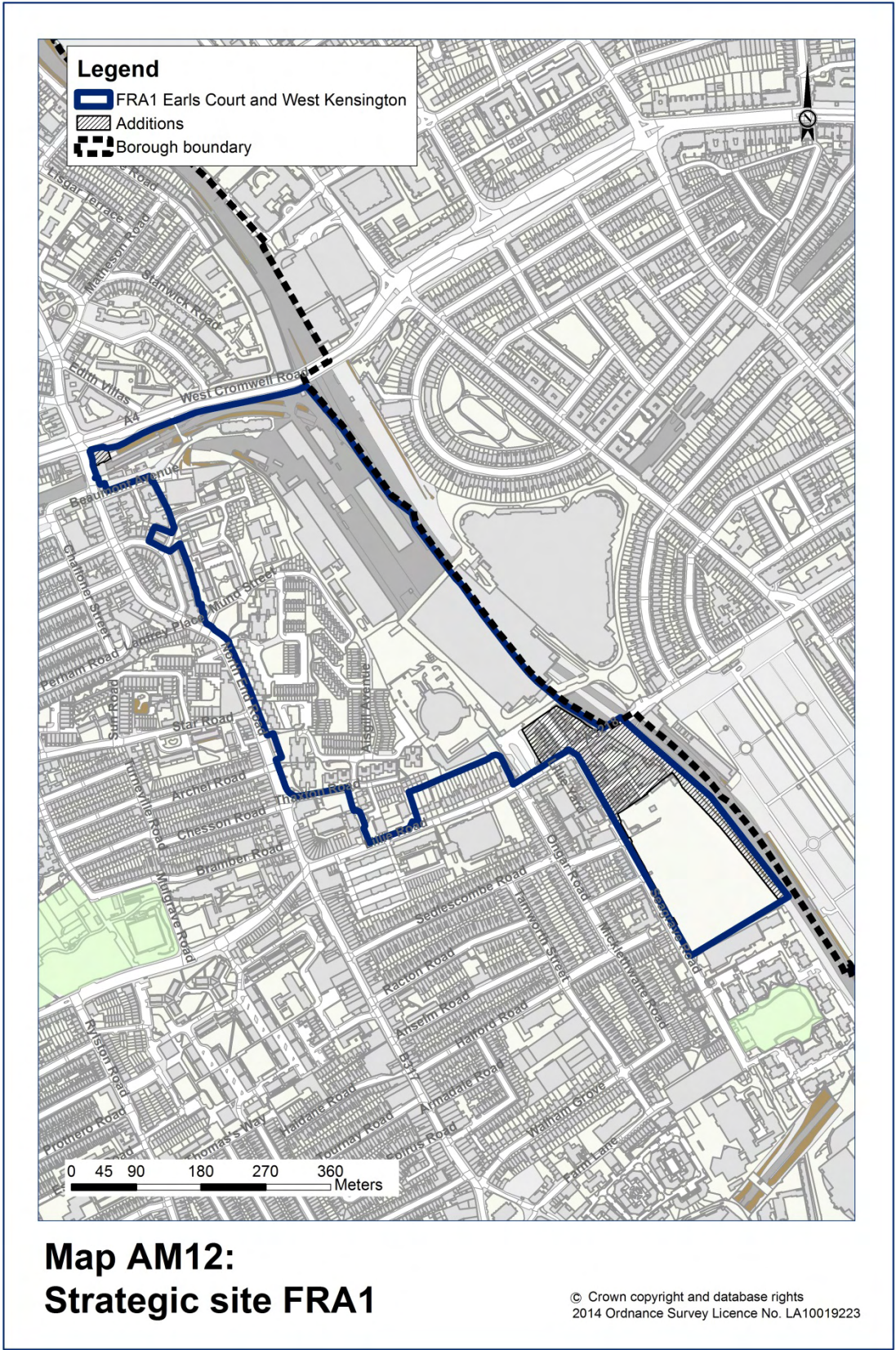



**Map AM13:  
Town Hall Extension and adjacent land, Nigel Playfair Avenue**



**Map AM14:  
King Street East (HRA2)**

© Crown copyright and database rights  
2014 Ordnance Survey Licence No. LA10019223

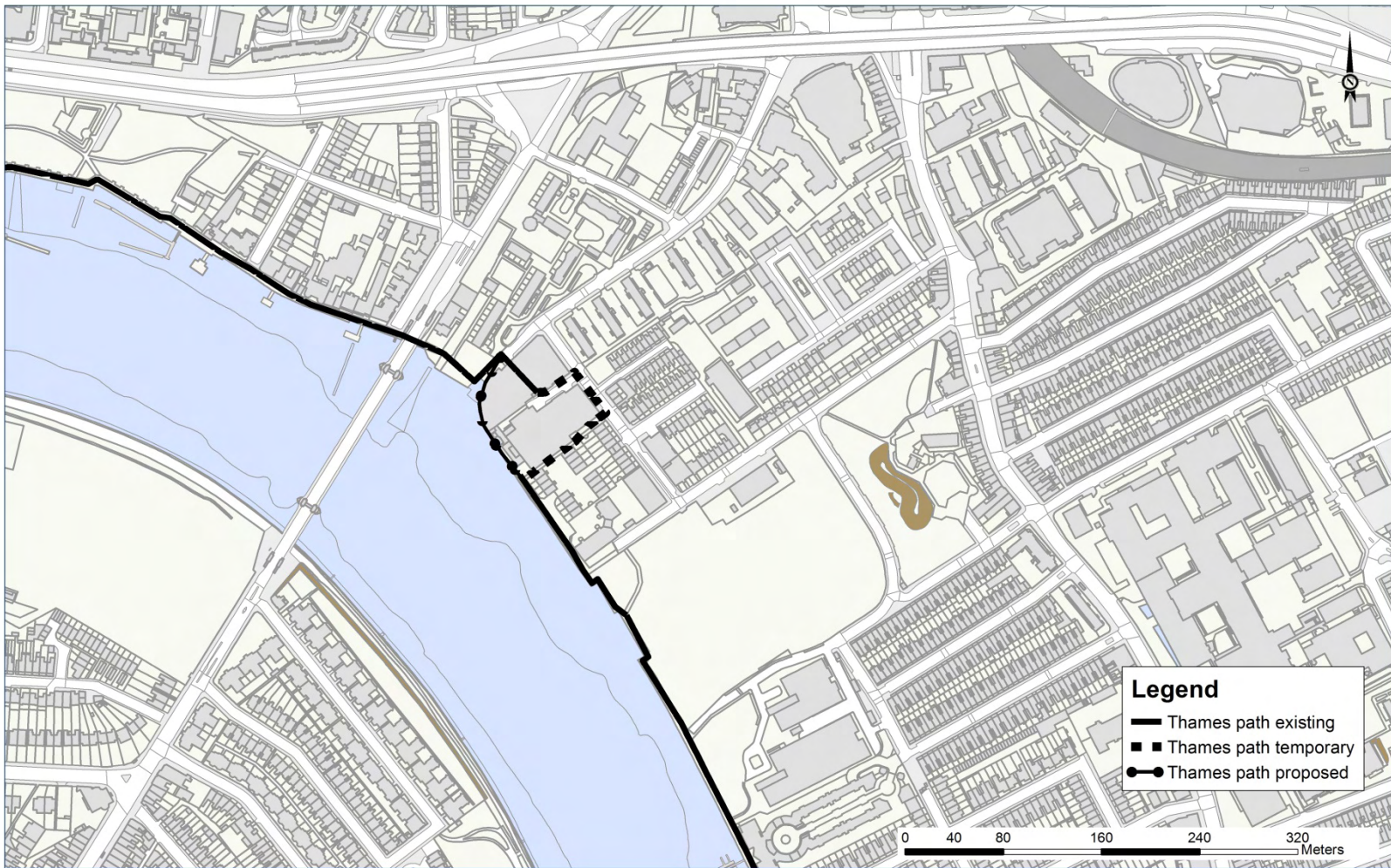

**Map AM15:  
Thames Path**

© Crown copyright and database rights  
2014 Ordnance Survey Licence No. LA10019223

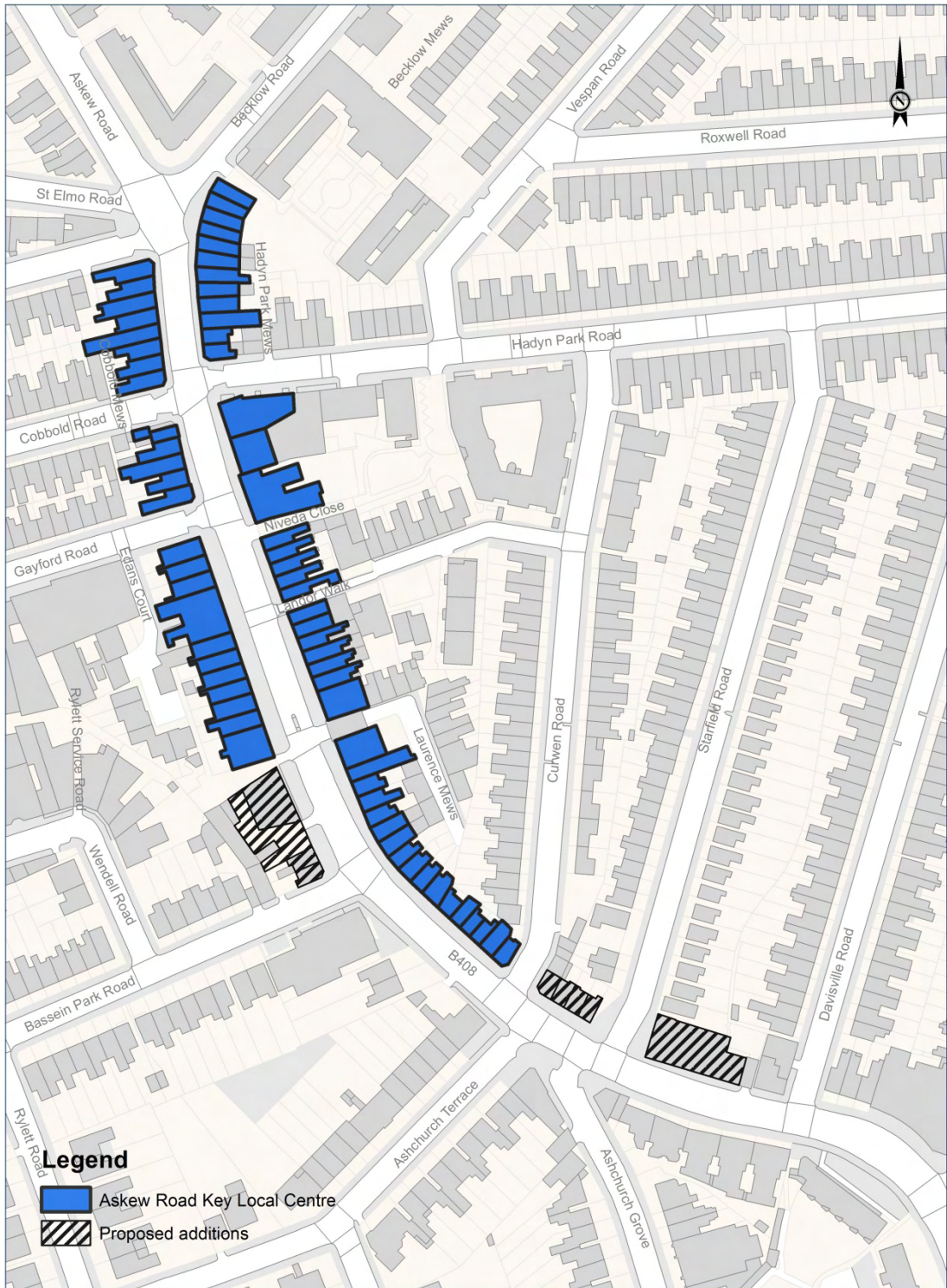



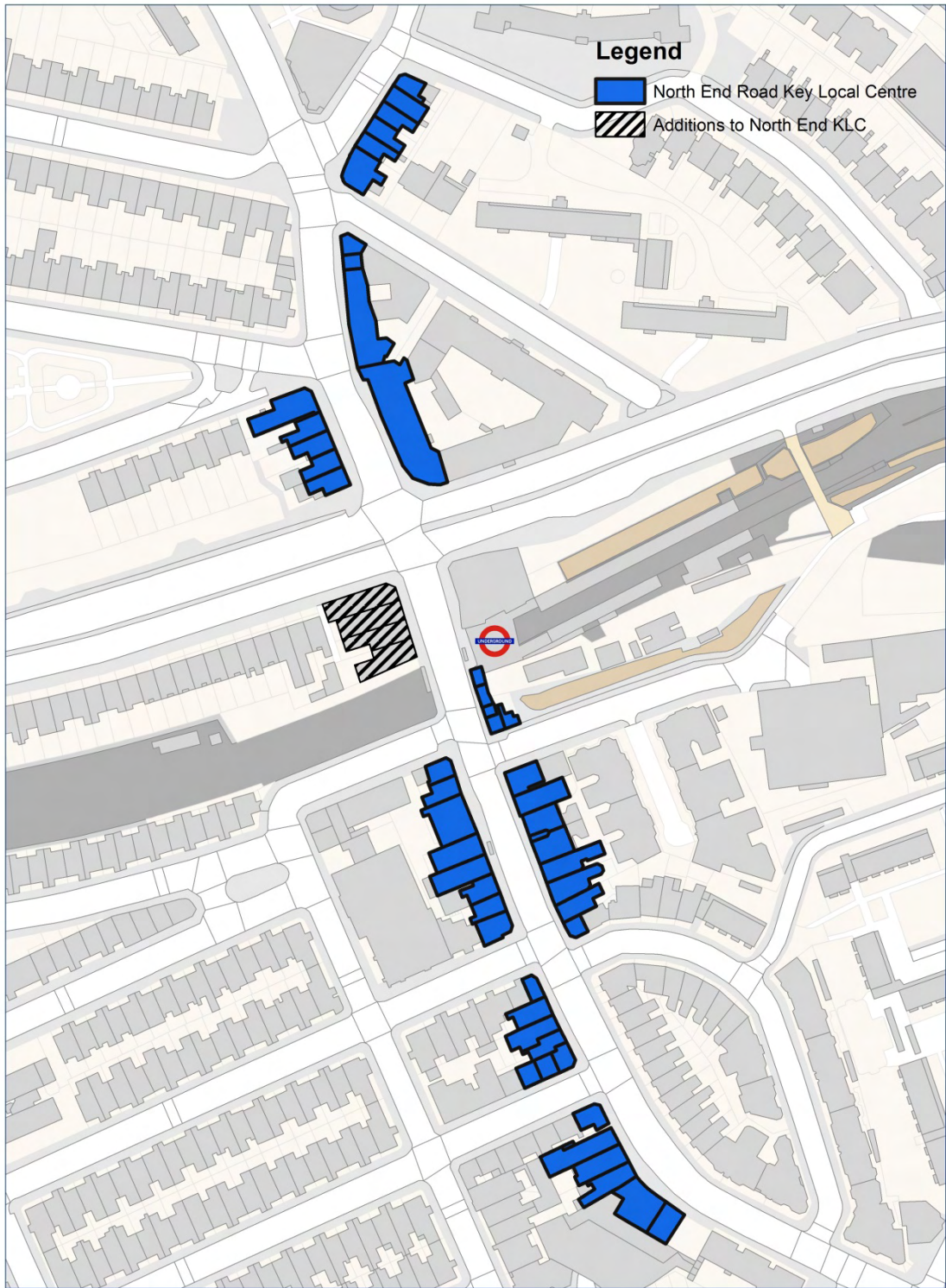

**Map AM17:  
North End Road KLC**

© Crown copyright and database rights  
2014 Ordnance Survey Licence No. LA10019223

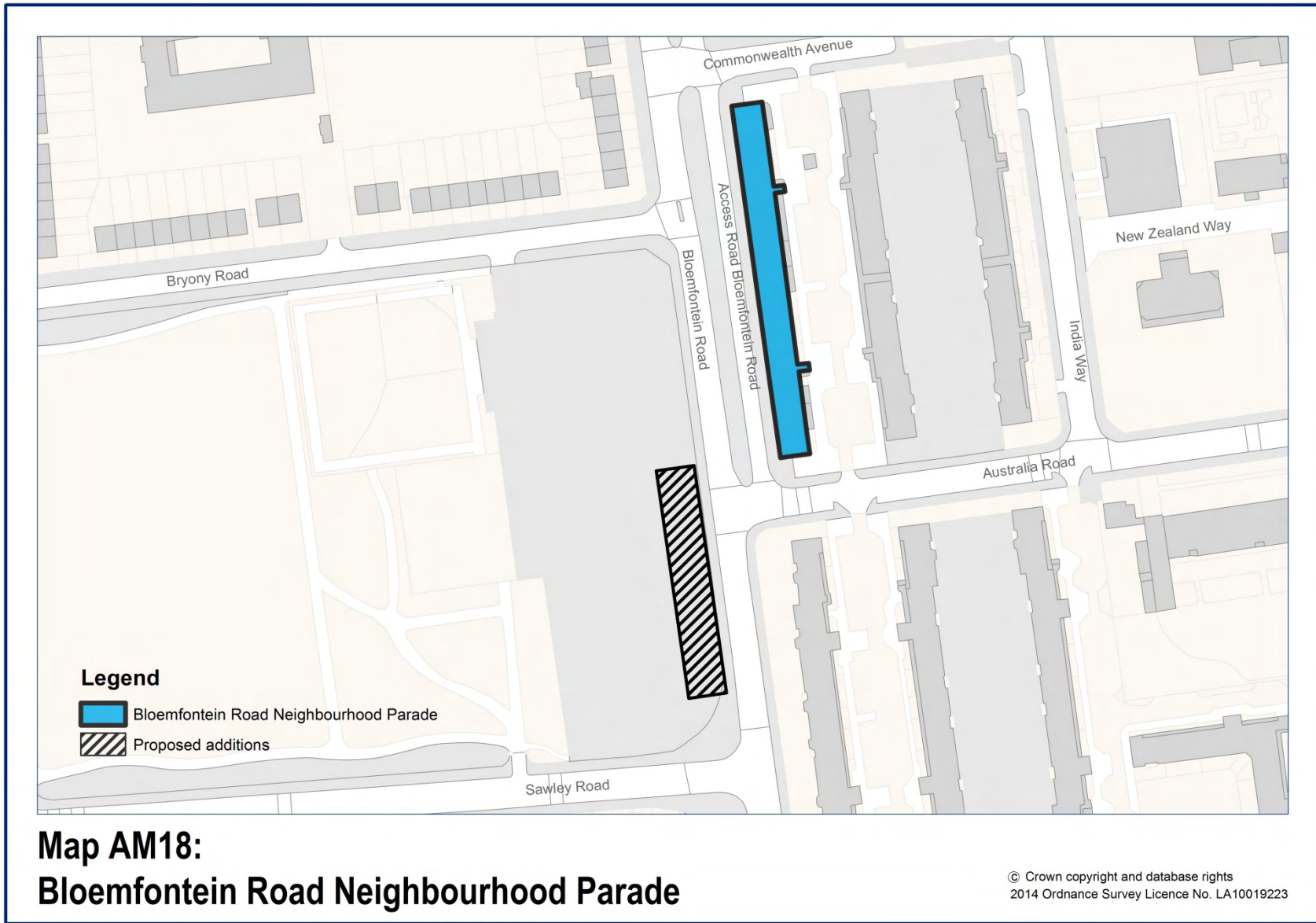

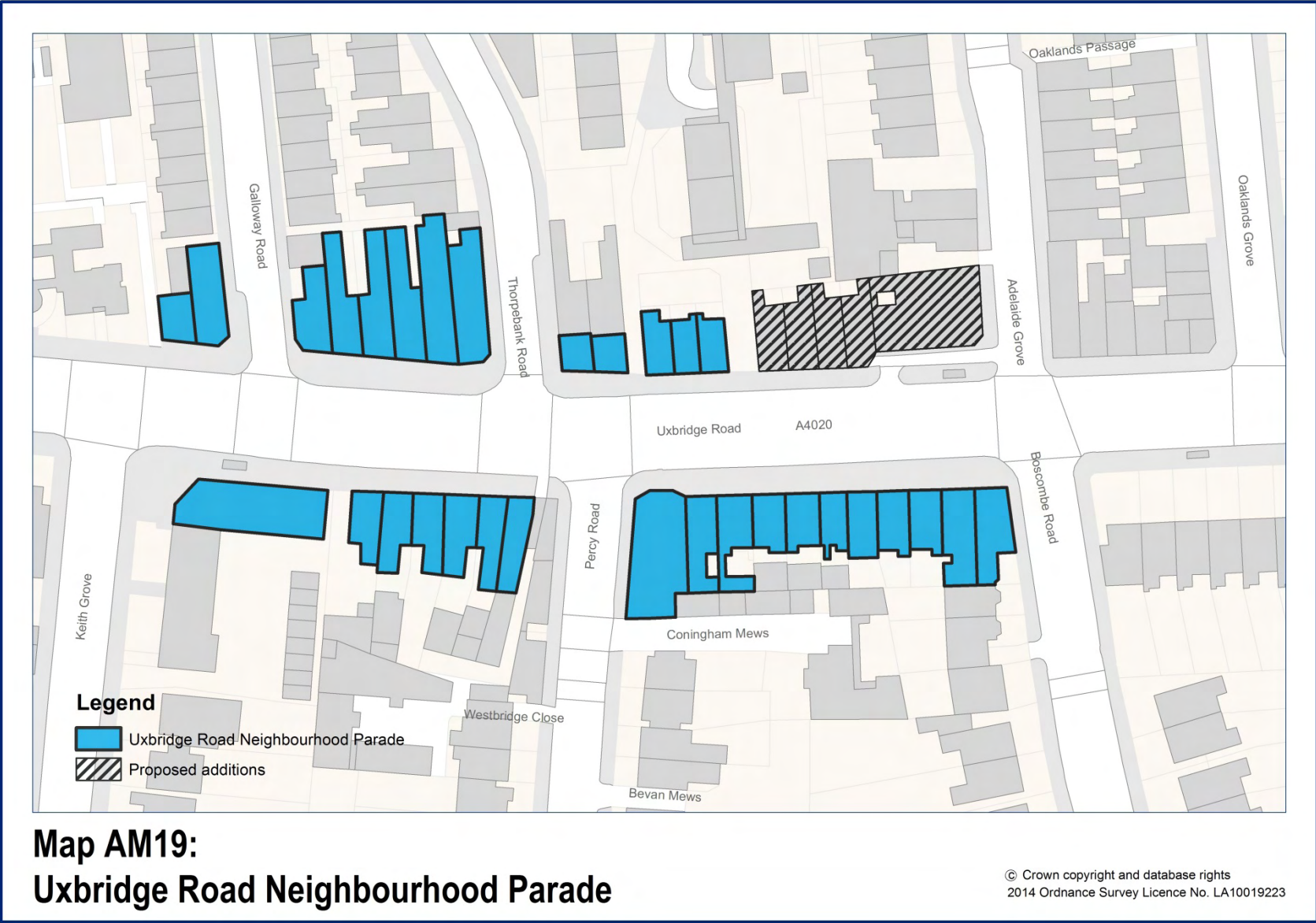

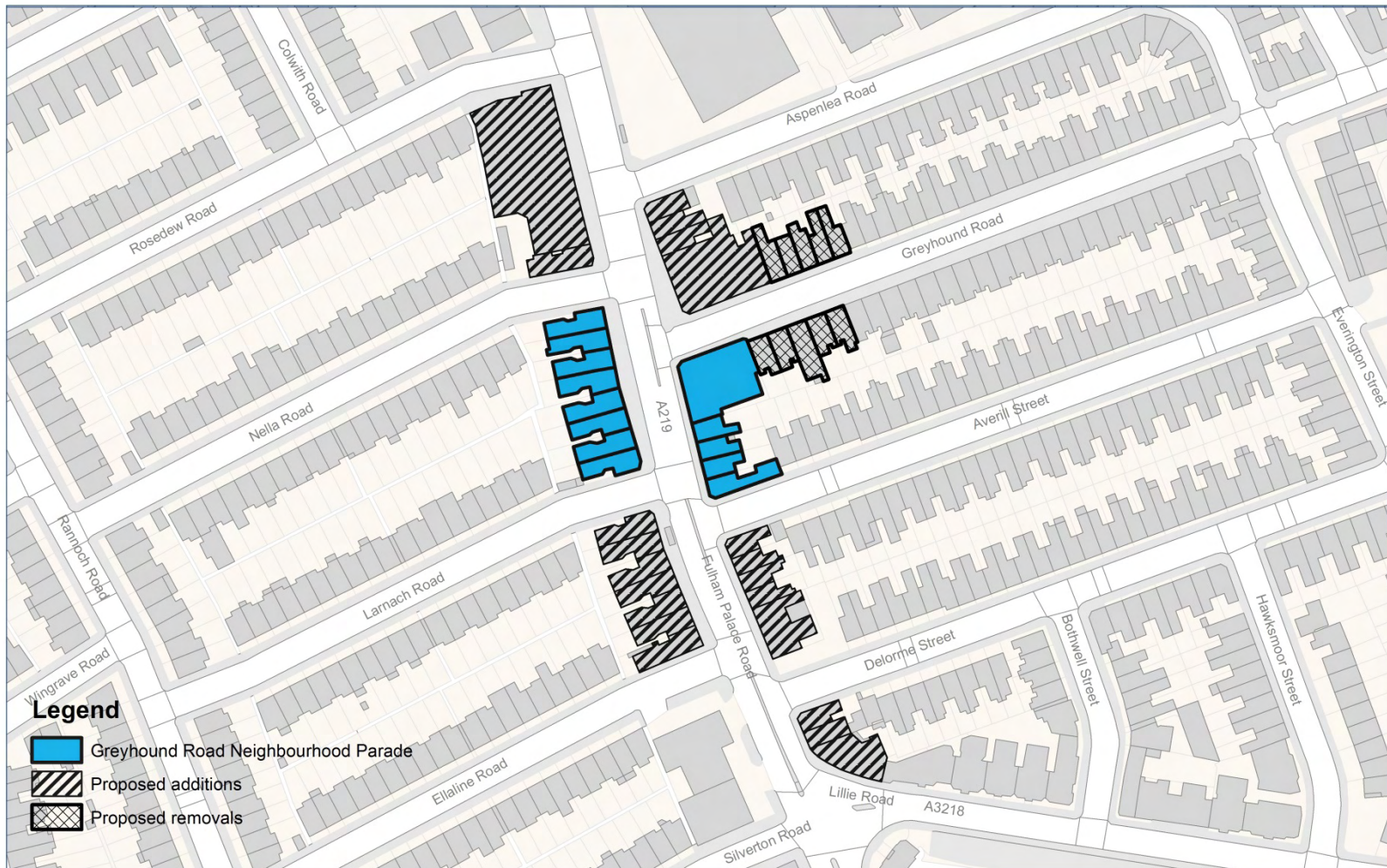

**Map AM20:**  
**Fulham Palace Road North (Greyhound Road) Neighbourhood Parade**

© Crown copyright and database rights  
 2014 Ordnance Survey Licence No. LA10019223

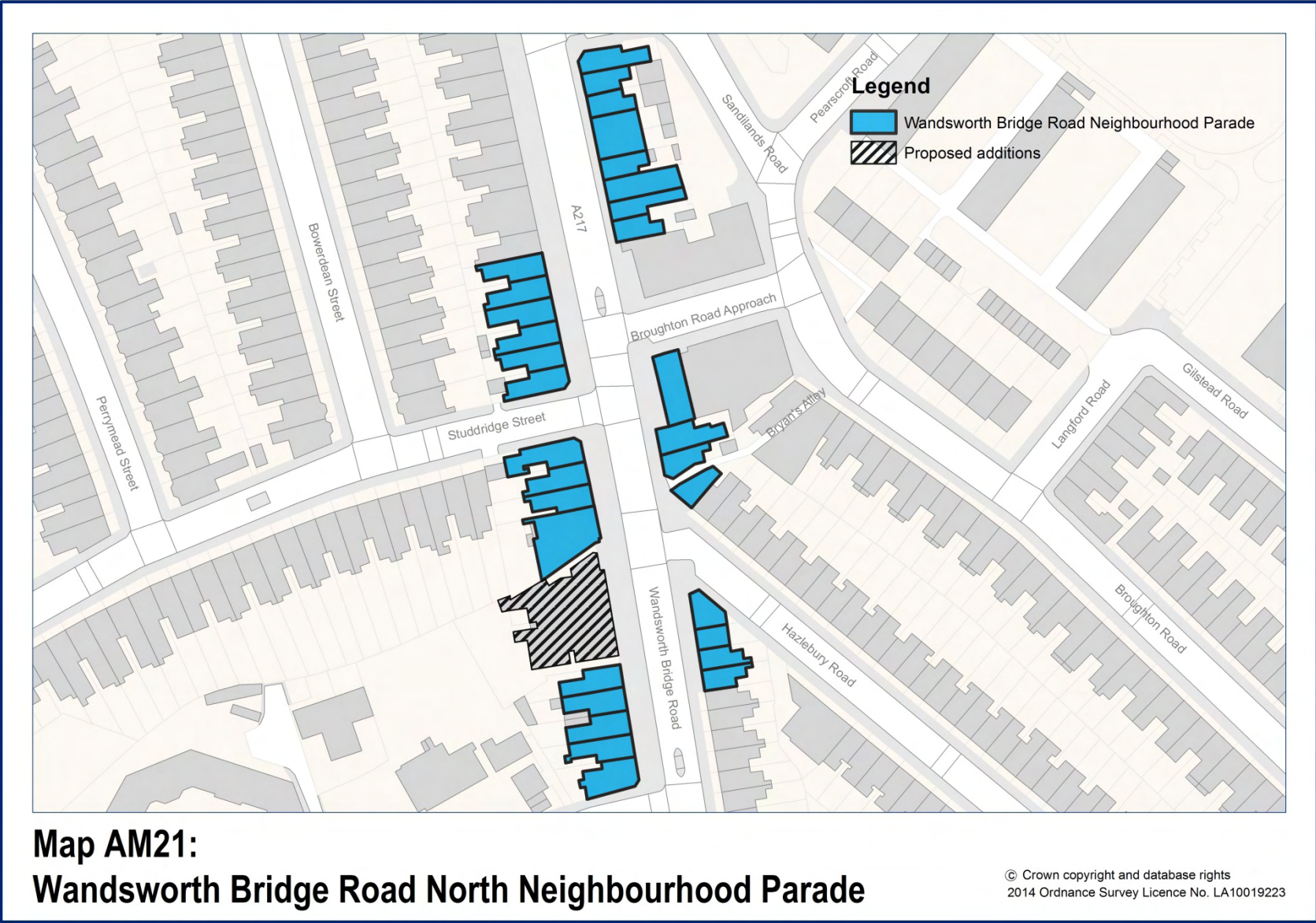

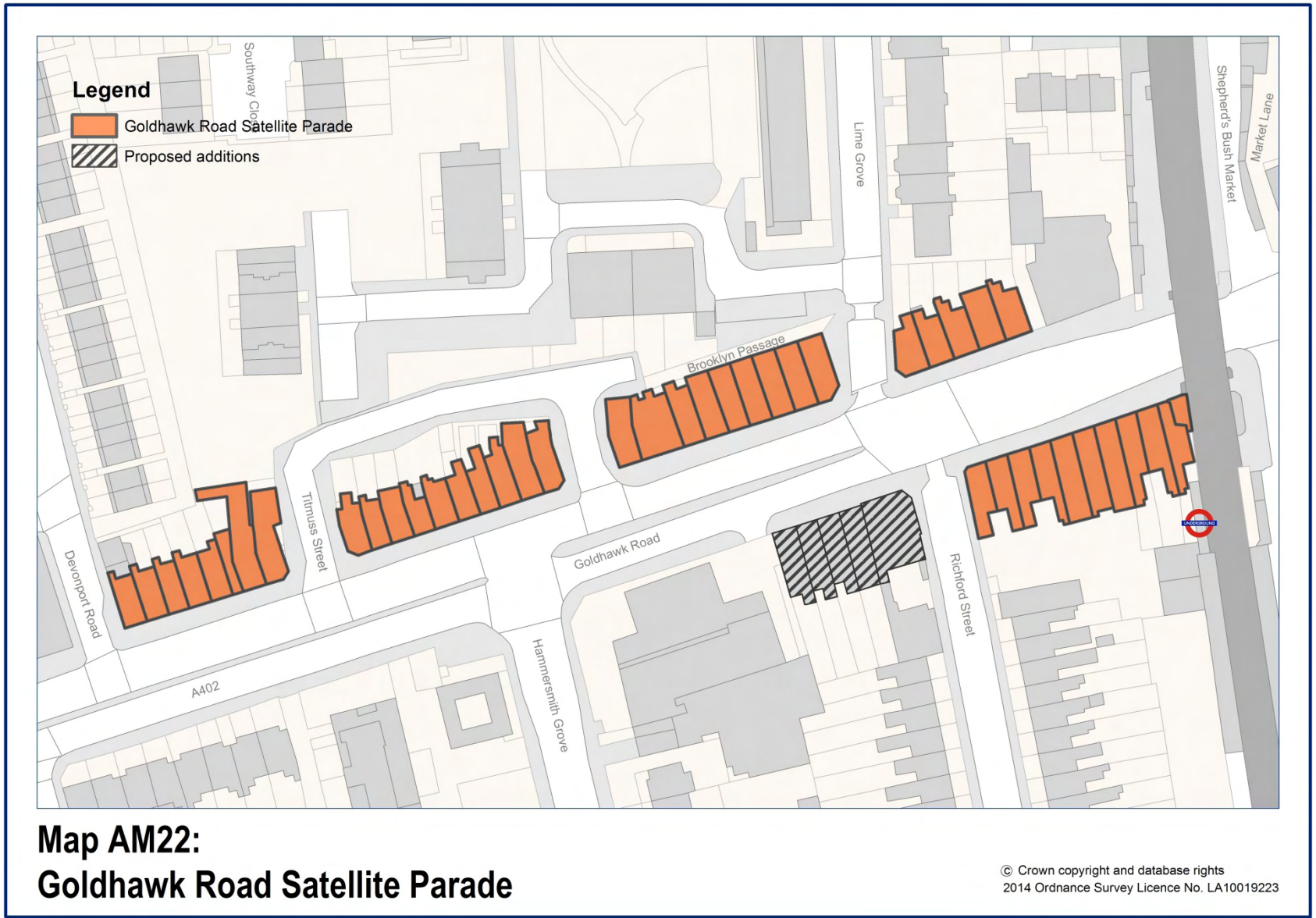

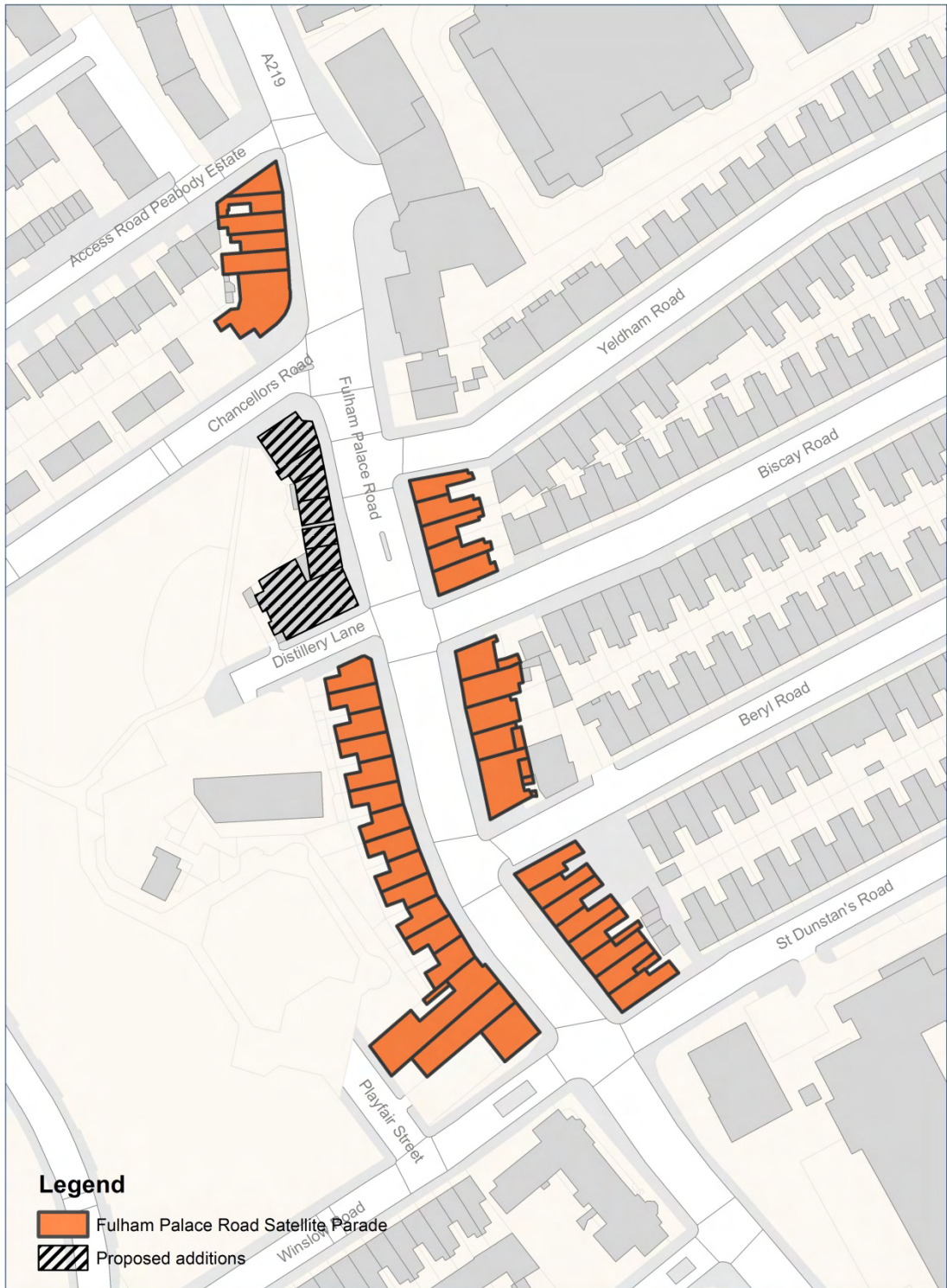

**Map AM23:  
Fulham Palace Road Satellite Parade**

© Crown copyright and database rights  
2014 Ordnance Survey Licence No. LA10019223

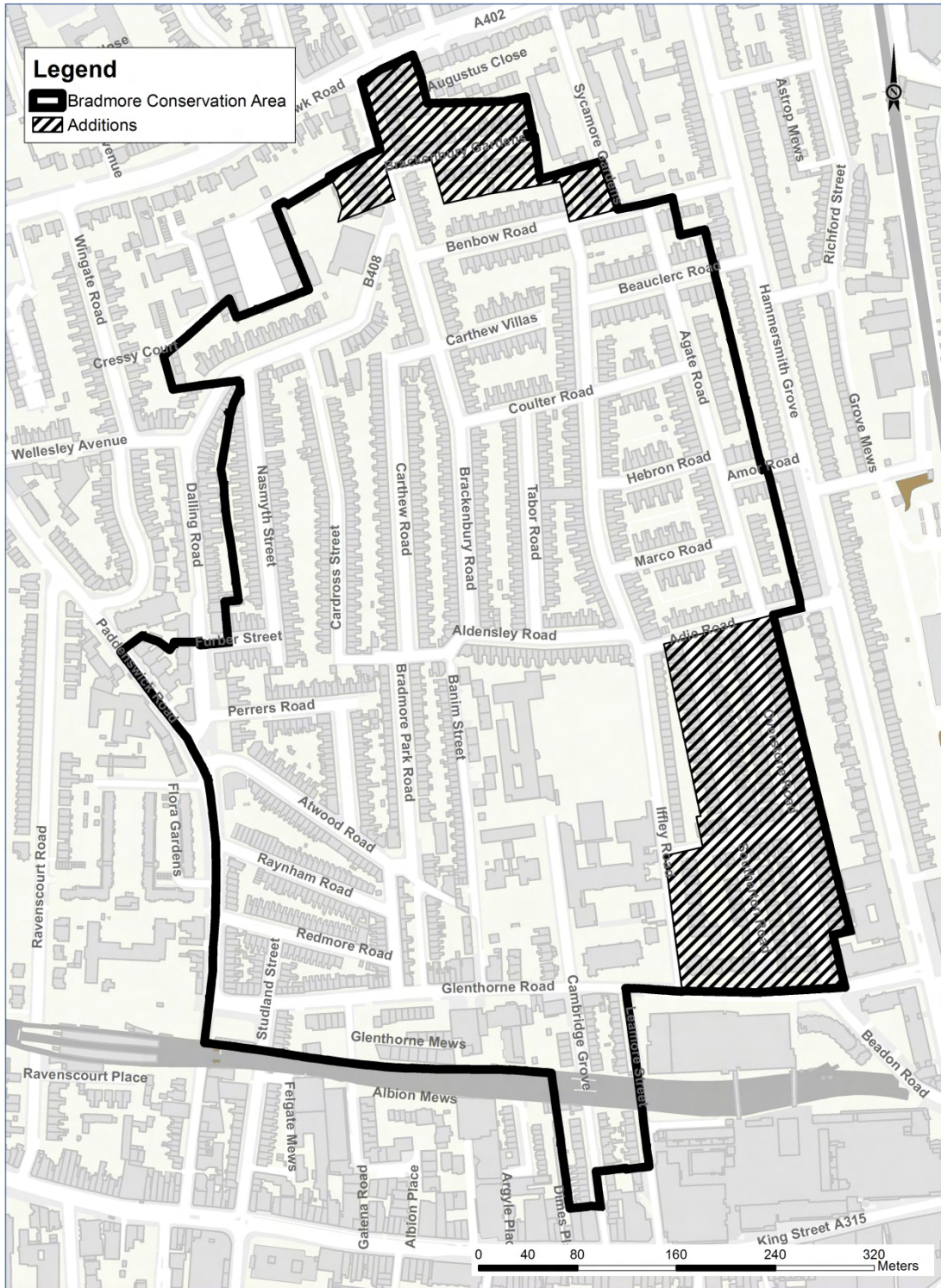

**Map AM24:  
Bradmore Conservation Area**

© Crown copyright and database rights  
2014 Ordnance Survey Licence No. LA10019223



